

# MEMOPOWER PLUS RT II SERIES

1~3kVA  
1:1 phase PF: 0.9



Two directions LCD display



Optional socket



Mini dry contact card



SNMP



Multifunctional bracket



Rack-Tower convertible



Battery Cabinets (Optional)

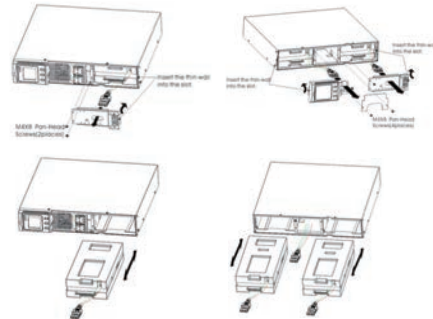

Easy for maintenance, hot-swappable battery

## Features

- Rack/Tower Convertible Design
- Patented Mimic LCD Display May be Rotated by Simply Pushing Front Button
- True Online Double Conversion
- High Output Power Factor at 0.9PF
- Comprehensive display allows easy monitoring and access of UPS status
- Smart SNMP works with either USB or RS-232 together
- Hot-Swappable Battery
- Efficiency up to 90%
- Estimated Remaining Time displayed on the LCD
- Support Economic (ECO) Operation Mode
- Matching Battery Pack
- Optional Powerful Charger
- Cold Start
- Power Shedding May Turn Off Uncritical Load in Battery Backup
- Emergency Power Off
- Frequency Converter Mode Is Settable

## Technical Specifications:

MODEL	MP RT II 1K(S/H)	MP RT II 1.5K(S/H)	MP RT II 2K(S/H)	MP RT II 3K(S/H)	
CAPACITY	1000VA/900W or 1000VA/800W	1500VA/1350W or 1000VA/1200W	2000VA/1800W or 2000VA/1600W	3000VA/2700W or 3000VA/2400W	
PHASE	Single phase with ground				
<b>INPUT</b>					
Nominal Voltage	200/208/220/230/240Vac or 100/110/115/120/127Vac				
Input Voltage Range	55~150Vac or 110~300Vac @ 60% load, 80~145Vac or 160~300Vac @ 100% load				
Frequency Range	45~55Hz/55~65Hz(auto-detect)				
Power Factor	≥0.99 @Nominal voltage(100% load)				
<b>OUTPUT</b>					
Output Voltage	200/208/220/230/240Vac or 100/110/115/120/127Vac				
Power Factor	0.9or0.8				
Voltage Regulation	±1%				
Frequency Range (Synchronized Range)	45~55Hz/56~64Hz				
Frequency Range (Batt.Mode)	50Hz/60Hz ± 0.1Hz				
Current Crest Ratio	3:1				
Harmonic Distortion	≤3% THD(Linear load) ≤6% THD(Non-linear load)				
Transfer Time	AC to DC	Zero			
	Inverter to Bypass	4ms(Typical)			
Waveform	Pure Sinewave				
<b>EFFICIENCY</b>					
AC Mode	88%	88%	89%	90%	
Battery Mode	83%	83%	85%	86%	
<b>BATTERY</b>					
Standard Model	Battery Type	12V/9AH	12V/9AH	12V/9AH	12V/9AH
	Numbers	2	3	4	6
	Backup Time	Estimated remaining time displayed on the LCD			
	Typical Recharge Time	4 hours recover to 90% capacity			
	Charging Current(max.)	1.0A			
	Charging Voltage	27.4Vdc ± 1%	41.1Vdc ± 1%	54.7Vdc ± 1%	82.1Vdc ± 1%
Long-run Model (Only HV Model)	Battery Numbers	Depending on the capacity of external batteries			
	Charging Current(max.)	6A/12A(double board)			
	Charging Voltage	27.4Vdc ± 1%	41.1Vdc ± 1%	54.7Vdc ± 1%	82.1Vdc ± 1%
<b>INDICATORS</b>					
LCD	Load level,Battery level,AC mode,Battery mode,Bypass mode,and Fault indicators				
<b>ALARM</b>					
Battery mode	Sounding every 4 seconds				
Low Battery	Sounding every second				
Overload	Sounding twice every second				
Fault	Continuously sounding				
<b>PHYSICAL</b>					
Standard model	Dimension,D×W×H(mm)	430×440×86.5		552×440×86.5	710×440×86.5
	Net Weight(kgs)	13.9	17.8	20.1	23.3
Long-run model (Only HV Model)	Dimension,D×W×H(mm)	430×440×86.5		552×440×86.5	
	Net Weight(kgs)	8.2		10.9	11.3
<b>ENVIRONMENT</b>					
Humidity	20~90% RH @ 0~40°C (Non-condensing)				
Noise level	<50dB @ 1 Meter				
<b>MANAGEMENT</b>					
Smart RS-232/USB	Supports Windows® 2000/2003/XP/Vista/2008 Windows® 7/8 Linux,FreeBSD and MAC				
Optional SNMP	Power management from SNMP manager and web browser				

Specifications are subject to change without prior notice.

## Technical Specifications:

MODEL ( Battery Pack)	RTII-BR04009	RTII-BR06009	RTII-BR08009	RTII-BR12009
CAPACITY (Vdc/AH)	24Vdc/9AH	36Vdc/9AH	48Vdc/9AH	72Vdc/9AH
<b>CHARGER INPUT</b>				
Voltage Range	150~285Vac or 80~145Vac			
Phase	Single phase with ground			
<b>CHARGER OUTPUT</b>				
Output Voltage	(27.4 ± 1)Vdc	(41.1 ± 1)Vdc	(54.8 ± 1)Vdc	(82.2 ± 1)Vdc
Charge Mode	CV mode			
Charging Current(Max)	1.4A			
Leakage current	<100uA			
Phase	Single phase with Battery ground			
<b>BATTERY</b>				
Number of Batteries Per Set	2	3	4	6
Number of Batteries Set	2			
Battery Type	12V/9Ah			
Backup Time	In accordance with the battery capacity and load			
Recharge Time	In accordance with the battery capacity			
Rated Battery Voltage	24Vdc	36Vdc	48Vdc	72Vdc
Battery Current protection	60A fast fuse			
Replace	Supports hot plug and play			
<b>MECHANICAL</b>				
Dimension (D × W × H)mm	430 × 440 × 86.5		542 × 440 × 86.5	720 × 440 × 86.5
Net Weight(kg)	TB			
<b>ENVIRONMENT</b>				
Safety	CE			
Operating Environment	0~40℃			
Relative Humidity	0~90%(non-condensing)			
Noise Level	<40dB@ 1Meter			
<b>I/O SOCKET</b>				
Input Socket	IEC320 C13-10A			
AC power cord	IEC320 C14-10A			
Battery Socket	Anderson like PowerPole Modular Connectors			

## **ОФИЦИАЛЬНЫЙ ДИЛЕР В УКРАИНЕ:**

[storgom.ua](http://storgom.ua)

## **ГРАФИК РАБОТЫ:**

Пн. – Пт.: с 8:30 по 18:30

Сб.: с 09:00 по 16:00

Вс.: с 10:00 по 16:00

## **КОНТАКТЫ:**

+38 (044) 360-46-77

+38 (066) 77-395-77

+38 (097) 77-236-77

+38 (093) 360-46-77

Детальное описание товара:

<https://storgom.ua/product/istochnikbespereboynogopitaniiakstarmemopowerplusmprt20-0subr20.html>

Другие товары: <https://storgom.ua/istochniki-bespereboinogo-pitaniia-ibp.html>